

Door closers

TESA

ASSA ABLOY



Closer selection

Standard Arm

EN Size	Width	Weight	CT550	CT1800 CT2550	CT2700	CT2800	CT300036 + BN3000	CT300057 + BN3057
1	75 cm	20 Kgs						
2	85 cm	40 Kgs	•	•	↕		•	
3	95 cm	60 Kgs	•	•	↕	↕	•	
4	110 cm	80 Kgs		•	↕	↕	•	
5	125 cm	100 Kgs				↕	•	
6	140 cm	120 Kgs				↕	•	•
7	160 cm	160 Kgs						↕
Traffic intensity			Medium	High	High	Very High	Extreme	Extreme



Sliding guide rail

EN Size	Width	Weight	CT2000D	CT2300	CT300036 + GD3000	CT4500	CT5000	CT5700
1	75 cm	20 Kgs			↕	↕	↕	
2	85 cm	40 Kgs	•		↕	↕	↕	
3	95 cm	60 Kgs	•	•	↕	↕	↕	
4	110 cm	80 Kgs			↕	↕	↕	
5	125 cm	100 Kgs					↕	
6	140 cm	120 Kgs					↕	•
7	160 cm	160 Kgs						↕
Traffic intensity			Medium	Medium	Extreme	Very High	Extreme	Extreme



Concealed

EN Size	Width	Weight	TEB 700	TEX14	TEX26
1	75 cm	20 Kgs			↕
2	85 cm	40 Kgs	•	↕	↕
3	95 cm	60 Kgs	•	↕	↕
4	110 cm	80 Kgs		↕	↕
5	125 cm	100 Kgs			↕
6	140 cm	120 Kgs			↕
7	160 cm	160 Kgs			↕
Traffic intensity			Medium	Very High	Very High



Floor springs

EN Size	Width	Weight	CTS070	CTS100	CTS200	CTS300
1	75 cm	100 Kgs				
2	85 cm	100 Kgs	•	↕	•	
3	95 cm	100 Kgs	•	↕	•	•
4	110 cm	100 Kgs	•	↕	•	↕
5	125 cm	300 Kgs				↕
6	140 cm	300 Kgs				↕
7	160 cm	300 Kgs				↕
Traffic intensity			Medium	High	High	Very High



Size coding: • Single fixed size • Selectable sizes by position
 ↕ Continuously Adjustable size with fine tune control

Link arm door closers

CT550

The CT550 is a door closer that offers good performance in a compact size.

It can drive doors from size 2 to 3. This means that the CT550 will feel comfortable closing doors weighing from 40 to 60 Kg. and up to 95 cm. door width.

This capability is achieved in a single model thanks to the variable position installation system.

- » Rack and pinion mechanism for smooth and reliable operation.
- » Two valves to adjust both sweep and latch speeds separately.
- » Two sizes (EN2&EN3) in a single model.
- » Reversible.
- » CT501 model permits to hold the door open at any position between 0° and 180°.
- » Suitable for doors opening inwards or outwards.:
 - Standard mounting: Door opens INWARDS, mounting on the pull side.
 - Transom mounting: Door opens OUTWARDS, mounting on the push side.
- » Four finishes: BL: White, NE: Black, PL: Silver

Classification according EN1154:1996+A1:2002

Standard arm transom mountings:

3 8 3 1 1 3

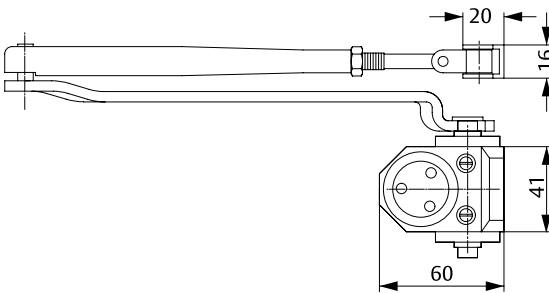

EN 1154 CERTIFIED

Fire door

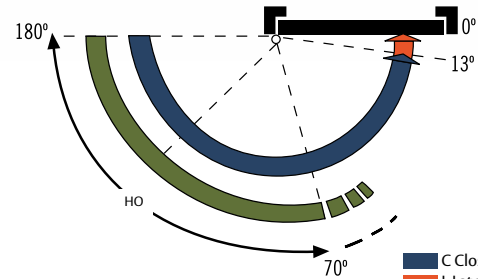

C Closing speed
L Latch speed
HO Hold open

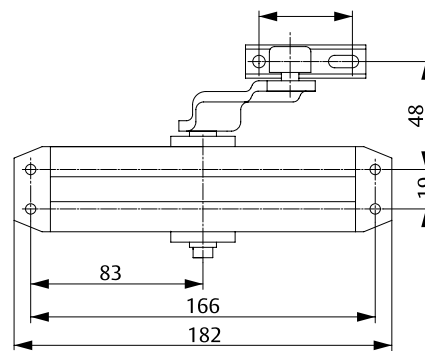

Model	Size	Door width cm	Door weight Kg	Opening	Adjustable
CT550	2	85	40	180°	S L
(non hold open)	3	95	60	180°	S L
CT501	2	85	40	180°	S L (70-180°)
(hold open)	3	95	60	180°	S L (70-180°)



Link arm door closers

CT1800

Multi size door-closer (2-3-4) by means of three mounting positions.
CT1800 has been EN1154 certified and hence valid for Fire Doors.

- » One model for three sizes: EN2, EN3 and EN4
- » Maximum opening up to 180° (depending on door hinges and environment). Up to 105° mounted at size 4.
- » Distance between fixing holes is 19 mm: CT1800 closers fit any aluminium door.
- » Reversible, non handed.
- » Finishes: White (BL), Black (NE), Silver (PL).

Classification with EN1154:1996+A1:2002

Standard arm transom mountings:

3 8 2/4 1 1 4

With parallell arm bracket SOP1800

3 8 3 1 1 4

EN 1154 CERTIFIED
Fire door 

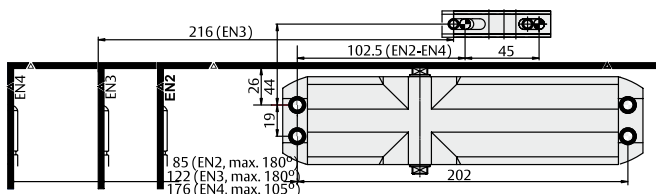
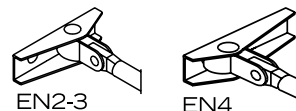
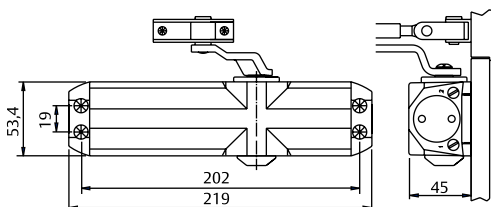
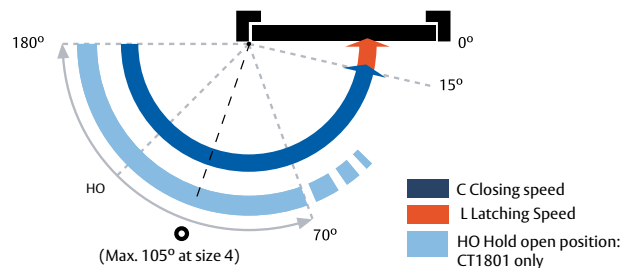

Standard mounting: Pull side

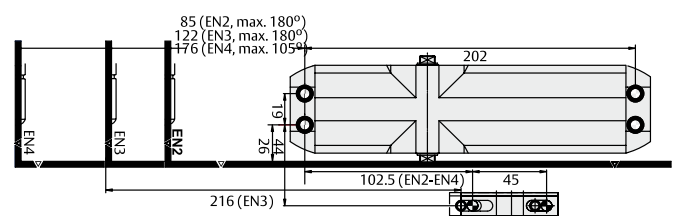

Transom mounting: Push side

Non hold open (EN1154 Certified)		
Size	Model	Finish
2 - 4	CT180034	BL - NE - PL - BR - OR
Hold open (Not suitable for fire doors)		
Size	Model	Finish
2 - 4	CT180134	BL - NE - PL - BR - OR
Paralell arm installation bracket		
Reference	Finish	
SOP1800	BL - BR - NE - OR - PL	

Size	Door Width cm	Door Weight Kg	Adjustment
2	85	40	VC - GF
3	95	60	VC - GF
4	110	80	VC - GF



SOP1800 Parallel Arm installation bracket.

Link arm door closers

CT2550

CT2550 closers stand out for their versatility and stylish design.

- » One model for three sizes: EN2, EN3 and EN4
- » Unique body and arm hole pattern for three sizes.
- » Maximum opening up to 180° (depending on door hinges and environment).
- » Sweep speed and latching speed fully adjustable with separate valves.
- » Backcheck valve to protect the door against violent openings. CT2550 model only.
- » CT2501: Includes adjustable hold open arm, for any door open position up to 180°.
- » Reversible, non handed.
- » Finishes: White (BL), Black (NE), Silver (PL).

EN 1154 CERTIFIED

Fire door



Classification according EN1154:1996+A1:2002

Standard arm transom mountings:

4 8 2/4 1 1 4

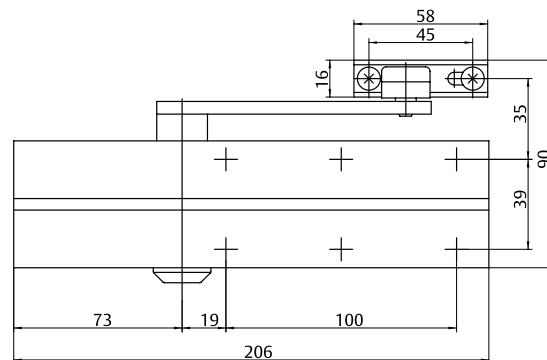
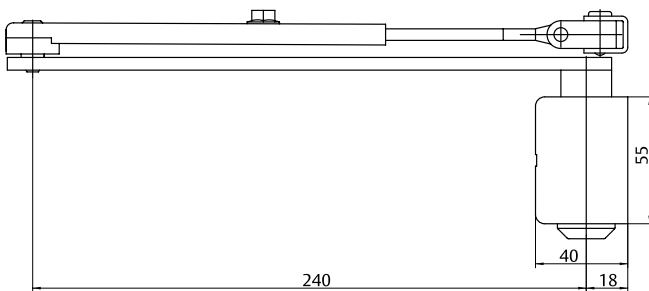
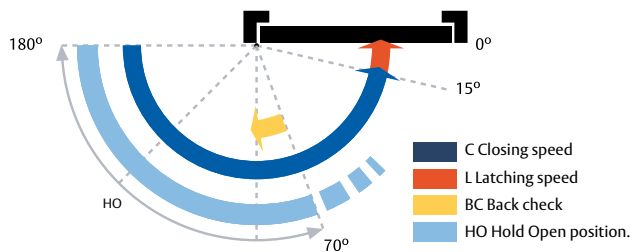

Size (EN 1154)	Ancho puerta cm	Peso puerta Kg
2	85	40
3	95	60
4	110	80

Non hold open (EN1154 certified)		
Size	Model	Finish
2 - 4	CT255034	BL - NE - PL
Hold open (Not suitable for fire doors)		
Size	Model	Finish
2 - 4	CT255134	BL - NE - PL